

## Pantry | Standard | 12 Deep | 2 Door

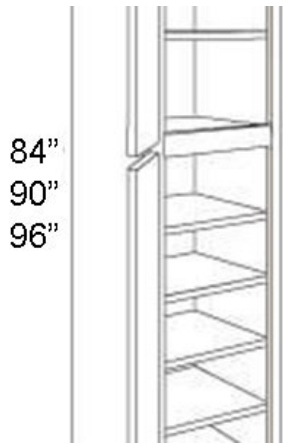

Price: \$180.00 - \$225.00

**SKU:** PAN-STD-12DP-2D

**Product Categories:** [Cabinets](#), [Pantry](#), [Standard](#)

**Product Page:**

<https://www.rccarpentry.ca/product/pantry-standard-12-deep-2-door/>

### Product Variants

- Pantry | Standard | 12 Deep | 2 Door ()Height:: 96, Width:: 18, Hinge:: Right
- Pantry | Standard | 12 Deep | 2 Door ()Height:: 96, Width:: 18, Hinge:: Left
- Pantry | Standard | 12 Deep | 2 Door ()Height:: 96, Width:: 15, Hinge:: Right
- Pantry | Standard | 12 Deep | 2 Door ()Height:: 96, Width:: 15, Hinge:: Left
- Pantry | Standard | 12 Deep | 2 Door ()Height:: 90, Width:: 18, Hinge:: Right
- Pantry | Standard | 12 Deep | 2 Door ()Height:: 90, Width:: 18, Hinge:: Left

- Pantry | Standard | 12 Deep | 2 Door ()Height:: 90, Width:: 15, Hinge:: Right
- Pantry | Standard | 12 Deep | 2 Door ()Height:: 90, Width:: 15, Hinge:: Left
- Pantry | Standard | 12 Deep | 2 Door ()Height:: 84, Width:: 18, Hinge:: Right
- Pantry | Standard | 12 Deep | 2 Door ()Height:: 84, Width:: 18, Hinge:: Left
- Pantry | Standard | 12 Deep | 2 Door ()Height:: 84, Width:: 15, Hinge:: Right
- Pantry | Standard | 12 Deep | 2 Door ()Height:: 84, Width:: 15, Hinge:: Left

## Product Summary

### Features

- Five adjustable shelves, top have metal shelf rest, bottom have locking clips

## Product Attributes

- Height:: 84, 90, 96
- Width:: 15, 18
- Hinge:: Left, Right